

承插焊钢制管法兰 HG/T20619-2009(SW) SOCKET WELDED STEEL PIPE FLANGE

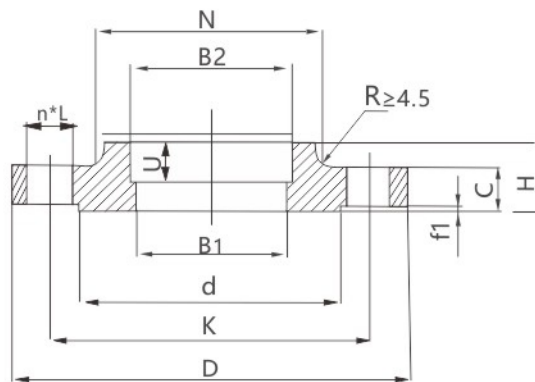

Class150(PN20) 承插焊钢制管法兰

(mm)

| 公称尺寸 Diameter | | 钢管 外径 A Pipe size A | 法兰 外径 D Flange outside diameter | | 连接尺寸 Diameter of contact face | | | 法兰 厚度 c Thickness | 法兰 内径 B1 Inner Diameter | | 承插孔 socket | | | 法兰颈 大端 N Flange neck big end | 法兰 高度 H Height | 理论 重量 Kg Weight | |
|------------------|-----|------------------------------------|---|-------|----------------------------------|----|------|----------------------------|-------------------------------------|------|---------------|------|------|---|-------------------------|--------------------------|------|
| DN | NPS | | K | L | n(个) Bolt hole number n | B2 | U | | | | | | | | | | |
| 15 | ½ | 21.3 | 90 | 88.9 | 60.3 | 16 | 15.7 | 4 | 9.6 | 15.5 | 15.7 | 22.5 | 22.4 | 10 | 30 | 14 | 0.42 |
| 20 | ¾ | 26.9 | 100 | 98.6 | 69.9 | 16 | 15.7 | 4 | 11.2 | 21 | 20.8 | 27.5 | 27.7 | 11 | 38 | 14 | 0.59 |
| 25 | 1 | 33.7 | 110 | 108 | 79.4 | 16 | 15.7 | 4 | 12.7 | 27 | 26.7 | 34.5 | 34.5 | 13 | 49 | 16 | 0.81 |
| 32 | 1¼ | 42.4 | 115 | 117.3 | 88.9 | 16 | 15.7 | 4 | 14.3 | 35 | 35.1 | 43.5 | 43.2 | 14 | 59 | 19 | 1.07 |
| 40 | 1½ | 48.3 | 125 | 127 | 98.4 | 16 | 15.7 | 4 | 15.9 | 41 | 40.9 | 49.5 | 49.5 | 16 | 65 | 21 | 1.36 |
| 50 | 2 | 60.3 | 150 | 152.4 | 120.7 | 18 | 19.1 | 4 | 17.5 | 52 | 52.6 | 61.5 | 62 | 17 | 78 | 24 | 2.1 |
| 65 | 2½ | 76.1 | 180 | 177.8 | 139.7 | 18 | 19.1 | 4 | 20.7 | 66 | 62.7 | 77.6 | 74.7 | 19 | 90 | 27 | 3.33 |
| 80 | 3 | 88.9 | 190 | 190.5 | 152.4 | 18 | 19.1 | 4 | 22.3 | 77.5 | 78 | 90.5 | 90.7 | 21 | 108 | 29 | 3.9 |

注：法兰内径B₁由钢管壁厚确定，用户应在订货时注明或按本标准附录C确定。表列法兰内径B₁相当于采用钢管壁厚为Sch40。

Note: The inner diameter B₁ of the flange is determined by the wall thickness of the steel pipe, and the user should indicate it when ordering or determine it according to Appendix C of this standard. The flange inner diameter B₁ listed in the table is equivalent to the steel pipe wall thickness of Sch40.

Class300(PN50) 承插焊钢制管法兰

| | | | | | | | | | | | | | | | | | |
|----|----|------|-----|-------|-------|----|------|---|------|------|------|------|------|----|-----|----|------|
| 15 | ½ | 21.3 | 95 | 88.9 | 66.7 | 16 | 15.7 | 4 | 12.7 | 15.5 | 15.7 | 22.5 | 22.4 | 10 | 38 | 21 | 0.66 |
| 20 | ¾ | 26.9 | 115 | 98.6 | 82.6 | 18 | 15.7 | 4 | 14.3 | 21 | 20.8 | 27.5 | 27.7 | 11 | 48 | 24 | 1.15 |
| 25 | 1 | 33.7 | 125 | 108 | 88.9 | 18 | 15.7 | 4 | 15.9 | 27 | 26.7 | 34.5 | 34.5 | 13 | 54 | 25 | 1.4 |
| 32 | 1¼ | 42.4 | 135 | 117.3 | 98.4 | 18 | 15.7 | 4 | 17.5 | 35 | 35.1 | 43.5 | 43.2 | 14 | 64 | 25 | 1.75 |
| 40 | 1½ | 48.3 | 155 | 127 | 114.3 | 22 | 15.7 | 4 | 19.1 | 41 | 40.9 | 49.5 | 49.5 | 16 | 70 | 29 | 2.55 |
| 50 | 2 | 60.3 | 165 | 152.4 | 127.0 | 18 | 19.1 | 8 | 20.7 | 52 | 52.6 | 61.5 | 62 | 17 | 84 | 32 | 2.93 |
| 65 | 2½ | 76.1 | 190 | 177.8 | 149.2 | 22 | 19.1 | 8 | 23.9 | 66 | 62.7 | 77.6 | 74.7 | 19 | 100 | 37 | 4.4 |
| 80 | 3 | 88.9 | 210 | 190.5 | 168.3 | 22 | 19.1 | 8 | 27.0 | 77.5 | 78 | 90.5 | 90.7 | 21 | 117 | 41 | 5.92 |

注：法兰内径B₁由钢管壁厚确定，用户应在订货时注明或按本标准附录C确定。表列法兰内径B₁相当于采用钢管壁厚为Sch40。

Note: The inner diameter B₁ of the flange is determined by the wall thickness of the steel pipe, and the user should indicate it when ordering or determine it according to Appendix C of this standard. The flange inner diameter B₁ listed in the table is equivalent to the steel pipe wall thickness of Sch40.

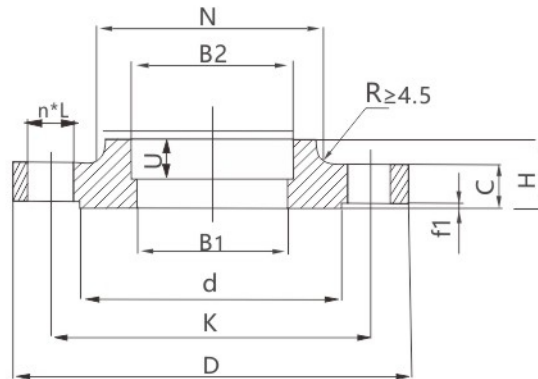
承插焊钢制管法兰 HG/T20619-2009(SW)
SOCKET WELDED STEEL PIPE FLANGE

Class600(PN110) 承插焊钢制管法兰

(mm)

| 公称尺寸 Diameter | | 钢管 外径 A Pipe size A | 法兰 外径 D Flange outside diameter | | 连接尺寸 Diameter of contact face | | | 法兰 厚度 c Thickness | 法兰 内径 B1 Inner Diameter | 承插孔 socket | | 法兰颈 大端 N Flange neck big end | 法兰 高度 H Height | 理论 重量 Kg Weight | | |
|------------------|-----|------------------------------------|---|-------|----------------------------------|----|------|----------------------------|-------------------------------------|---------------|------|---|-------------------------|--------------------------|----|------|
| DN | NPS | | K | L | n(个) | B2 | U | | | | | | | | | |
| 15 | ½ | 21.3 | 95 | 88.9 | 66.7 | 16 | 15.7 | 4 | 14.3 | - | 22.5 | 22.4 | 10 | 38 | 22 | 0.76 |
| 20 | ¾ | 26.9 | 115 | 98.6 | 82.6 | 18 | 15.7 | 4 | 15.9 | - | 27.5 | 27.7 | 11 | 48 | 25 | 1.29 |
| 25 | 1 | 33.7 | 125 | 108 | 88.9 | 18 | 15.7 | 4 | 17.5 | - | 34.5 | 34.5 | 13 | 54 | 27 | 1.55 |
| 32 | 1¼ | 42.4 | 135 | 117.3 | 98.4 | 18 | 15.7 | 4 | 20.7 | - | 43.5 | 43.2 | 14 | 64 | 29 | 2.06 |
| 40 | 1½ | 48.3 | 155 | 127 | 114.3 | 22 | 15.7 | 4 | 22.3 | - | 49.5 | 49.5 | 16 | 70 | 32 | 3.00 |
| 50 | 2 | 60.3 | 165 | 152.4 | 127.0 | 18 | 19.1 | 8 | 25.4 | - | 61.5 | 62 | 17 | 84 | 37 | 3.67 |
| 65 | 2½ | 76.1 | 190 | 177.8 | 149.2 | 22 | 19.1 | 8 | 28.6 | - | 77.6 | 74.7 | 19 | 100 | 41 | 5.35 |
| 80 | 3 | 88.9 | 210 | 190.5 | 168.3 | 22 | 19.1 | 8 | 31.8 | - | 90.5 | 90.7 | 21 | 117 | 46 | 7.06 |

注：法兰内径B₁由钢管壁厚确定，用户应在订货时注明或按本标准附录C确定。表列法兰内径B₁相当于采用钢管壁厚为Sch40。

Note: The inner diameter B₁ of the flange is determined by the wall thickness of the steel pipe, and the user should indicate it when ordering or determine it according to Appendix C of this standard. The flange inner diameter B₁ listed in the table is equivalent to the steel pipe wall thickness of Sch40.

Class900(PN150) / Class1500(PN260) 承插焊钢制管法兰

| | | | | | | | | | | | | | | | | |
|----|----|------|-----|-------|-------|----|------|---|------|---|------|------|----|-----|----|------|
| 15 | ½ | 21.3 | 120 | 120.6 | 82.6 | 22 | 22.3 | 4 | 22.3 | - | 22.5 | 22.4 | 10 | 38 | 32 | 1.8 |
| 20 | ¾ | 26.9 | 130 | 130 | 88.9 | 22 | 22.3 | 4 | 25.4 | - | 27.5 | 27.7 | 11 | 44 | 35 | 2.41 |
| 25 | 1 | 33.7 | 150 | 149.3 | 101.6 | 26 | 25.4 | 4 | 28.6 | - | 34.5 | 34.5 | 13 | 52 | 41 | 3.55 |
| 32 | 1¼ | 42.4 | 160 | 158.7 | 111.1 | 26 | 25.4 | 4 | 28.6 | - | 43.5 | 43.2 | 14 | 64 | 41 | 4.02 |
| 40 | 1½ | 48.3 | 180 | 177.8 | 123.8 | 30 | 28.4 | 4 | 31.8 | - | 49.5 | 49.5 | 16 | 70 | 44 | 5.45 |
| 50 | 2 | 60.3 | 215 | 215.9 | 165.1 | 26 | 25.4 | 8 | 38.1 | - | 61.5 | 62 | 17 | 105 | 57 | 10.2 |
| 65 | 2½ | 76.1 | 245 | 244.3 | 190.5 | 30 | 28.4 | 8 | 41.3 | - | 77.6 | 74.7 | 19 | 124 | 64 | 13.9 |

注：法兰内径B₁由钢管壁厚确定，用户应在订货时注明或按本标准附录C确定。表列法兰内径B₁相当于采用钢管壁厚为Sch40。

Note: The inner diameter B₁ of the flange is determined by the wall thickness of the steel pipe, and the user should indicate it when ordering or determine it according to Appendix C of this standard. The flange inner diameter B₁ listed in the table is equivalent to the steel pipe wall thickness of Sch40.