

# Caps

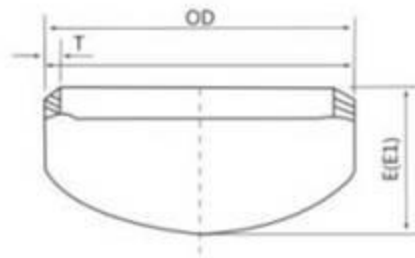

Nominal diameter		Outside diameter	Back to end		Approx weight KG/PC					
DN	NPS		E	E1	sch5s	sch10s	sch40S/STD	sch40	sch80S/XS	sch80
15	1/2	18	25	25	0.019	0.024	0.031	0.031	0.042	0.042
		21.3			0.022	0.028	0.037	0.037	0.05	0.05
20	3/4	25	25	25	0.027	0.033	0.045	0.045	0.06	0.06
		26.7			0.029	0.035	0.048	0.048	0.065	0.065
25	1	32	38	38	0.049	0.083	0.101	0.101	0.136	0.136
		33.7			0.052	0.087	0.106	0.106	0.143	0.143
32	1 1/4	28	38	38	0.058	0.099	0.126	0.126	0.173	0.173
		42.4			0.065	0.11	0.141	0.141	0.193	0.193
40	1 1/2	45	38	38	0.071	0.118	0.158	0.158	0.218	0.218
		48.3			0.076	0.127	0.169	0.169	0.234	0.234
50	2	57	38	44	0.094	0.156	0.221	0.221	0.313	0.313
		60.3			0.099	0.165	0.234	0.234	0.331	0.331
65	2 1/2	76	38	51	0.167	0.241	0.409	0.409	0.555	0.555
		73			0.161	0.232	0.393	0.393	0.534	0.534
80	3	89	51	64	0.254	0.367	0.66	0.66	0.917	0.917
90	3 1/2	101.6	64	76	0.355	0.512	0.965	0.965	1.36	1.36
100	4	108	64	76	0.387	0.561	1.11	1.11	1.58	1.58
		114.3			0.41	0.594	1.17	1.17	1.67	1.67
125	5	133	76	89	0.769	0.945	1.82	1.82	2.65	2.65
		139.7			0.808	0.993	1.91	1.91	2.78	2.78
		141.3			0.817	1	1.93	1.93	2.81	2.81
150	6	159	89	102	1.07	1.31	2.74	2.74	4.22	4.22
		168.3			1.13	1.39	2.9	2.9	4.47	4.47
		165.2			1.11	1.36	2.85	2.85	4.39	4.39
200	8	219	102	127	1.76	2.38	5.19	5.19	8.05	8.05
		216.1			1.74	2.35	5.13	5.13	7.95	7.95
250	10	273	127	152	3.36	4.14	9.15	9.15	12.5	16.3
		267.4			3.29	4.05	8.96	8.96	12.2	16.4

Above dimensions acc. to GB/T 12459、GBAT 13401、SH 3408、SH 3409、HG/T 21635、HG/T 21631、SY/T 05010、ASME B16.9.  
Weights are approximate and based on manufacture's data, according to ANSIB16.9

# Caps

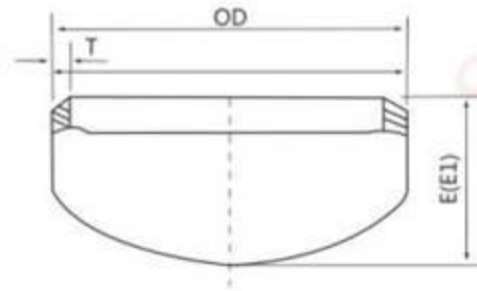

Nominal diameter		Outside diameter	Back to end		Approx weight KG/PC					
DN	NPS		E	E1	sch5s	Sch10s	sch40S/STD	sch40	sch80S/XS	sch80
300	12	325	152	178	5.12	6.4	13.5	14.6	17.9	28.3
		323.9			5.11	6.39	13.3	14.4	17.7	27.1
		318.5			5.02	6.27	13.2	14.2	17.3	26.8
350	14	377	165	191	6	8.46	16.9	19.9	22.5	38.5
		355.6			5.66	7.87	15.9	18.8	21.2	35.2
400	16	426	178	203	6.93	7.91	21	28.2	28	52.0
		406.4			6.6	7.53	20	20	26.7	49.1
450	18	478	203	229	7.9	9.01	26.9	43.8	35.8	76.1
		457.2			7.52	8.58	25.6	41.4	34.1	69.1
500	20	529	229	254	10.5	12.02	33.2	57.6	44.2	103
		508			10.1	11.7	31.9	54	42.5	93.7
550	22	559	254	254	12.1	22.6	38.8	78.3	51.7	116
600	24	630	267	305	14.8	16.9	46.5	92.3	61.9	177
		610			14.3	16.4	45.1	90.1	60.1	160
650	26	660	267	-	23.3	26.1	50.5	103.5	67.3	-
700	28	720	267	-	27.1	32.4	56.9	151.1	75.6	-
		711		-	38.7	49.7	56.2	121.3	74.9	-
750	30	762	267	-	41.4	51.7	62.1	117.3	82.8	-
800	32	820	267	-	43.4	58.3	70.6	127	92	-
		813		-	43.1	57.7	70	126	91.2	-
850	34	864	267	-	57.2	68.5	78.7	144	105	-
900	36	920	267	-	60.3	74.6	86.3	172	115	-
		914		-	59.1	72.1	85.7	171	114	-

Above dimensions acc. to GB/T 12459、GBAT 13401、SH 3408、SH 3409、HG/T 21635、HG/T 21631、SY/T 05010、ASME B16.9.  
Weights are approximate and based on manufacture's data, according to ANSIB16.9